

BERETTA

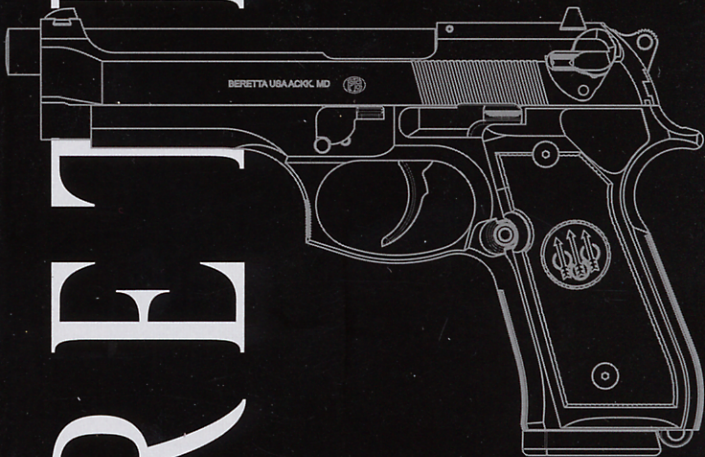

M9.22

M9A1.22

92FS.22

Cal. .22 L.R.
INSTRUCTION MANUAL



ALWAYS KEEP THIS MANUAL WITH YOUR FIREARM. INCLUDE IT WITH THE FIREARM WHEN IT CHANGES OWNERSHIP OR WHEN IT IS LOANED OR PRESENTED TO ANOTHER PERSON.

Notice: The Manufacturer and/or its Local Official Distributors assume no responsibility for product malfunction or for physical injury or property damage resulting in whole or in part from criminal or negligent use of the product, improper or careless handling, unauthorized modifications, use of defective, improper, hand-loaded, reloaded or remanufactured ammunition, customer abuse or neglect of the product, or other influences beyond manufacturer's direct and immediate control.

WARNING: ALL FIREARMS HAVE LETHAL POTENTIAL. READ THE BASIC SAFETY RULES CAREFULLY AND UNDERSTAND THEM FULLY BEFORE ATTEMPTING TO USE THIS FIREARM.

In addition to the Basic Safety Rules, there are other Safety Rules pertaining to the loading, unloading, disassembly, assembly and use of this firearm, located throughout this manual.

WARNING: READ THE ENTIRE MANUAL CAREFULLY BEFORE USING THIS FIREARM. MAKE SURE THAT ANY PERSON USING OR HAVING ACCESS TO THIS FIREARM READS AND UNDERSTANDS ALL OF THIS MANUAL PRIOR TO USE OR ACCESS.

WARNING: IN ORDER TO PERMIT THE USE OF THE 90 SERIES .22LR PISTOL IN ALL SITUATIONS, EVEN IN THE CASE OF INVOLUNTARY DROPPING OR LOSS OF THE MAGAZINE, THESE MODELS ARE NOT PROVIDED WITH A MAGAZINE DISCONNECT SAFETY. THE FIREARM IS THEREFORE CAPABLE OF FIRING, IF A ROUND IS CHAMBERED, EVEN IF THE MAGAZINE HAS NOT BEEN INSERTED OR IF IT HAS BEEN REMOVED OR IF IT HAS BEEN DISLODGED FROM ITS SEAT.

WE RECOMMEND THE USE OF ORIGINAL BERETTA SPARE PARTS AND ACCESSORIES. THE USE OF OTHER MANUFACTURER'S SPARE PARTS AND ACCESSORIES COULD CAUSE MALFUNCTIONS AND/OR BREAKAGES THAT WILL NOT BE COVERED BY THE BERETTA WARRANTY.

CONTENTS

	Page
BASIC SAFETY RULES	4
NOMENCLATURE	10
DESCRIPTION	11
SAFETY FEATURES	11-12
OPERATIONAL FEATURES	12-13
GENERAL OPERATION	13
SPECIFICATIONS	14
TECHNICAL DATA	14
LOADING AND FIRING	15-17
UNLOADING THE PISTOL AND THE CHAMBER	18
DISASSEMBLY	19
CLEANING AND LUBRICATING	20
ASSEMBLY	21
AMMUNITION	23-24
TROUBLESHOOTING	25-27
MAINTENANCE	28-29



BASIC SAFETY RULES

WARNING: PLEASE READ THIS MANUAL BEFORE HANDLING YOUR FIREARM.

WARNING: FIREARMS CAN BE DANGEROUS AND CAN POTENTIALLY CAUSE SERIOUS INJURY, DAMAGE TO PROPERTY OR DEATH, IF HANDLED IMPROPERLY. THE FOLLOWING SAFETY RULES ARE AN IMPORTANT REMINDER THAT FIREARM SAFETY IS YOUR RESPONSIBILITY.

1. NEVER POINT A FIREARM AT SOMETHING THAT IS NOT SAFE TO SHOOT.

Never let the muzzle of a firearm point at any part of your body or at another person. This is especially important when loading or unloading the firearm. When you are shooting at a target, know what is behind it. Some bullets can travel over a mile. If you miss your target or if the bullet penetrates the target, it is your responsibility to ensure that the shot does not cause unintended injury or damage.



2. ALWAYS TREAT A FIREARM AS IF IT WERE LOADED.

Never assume that a firearm is unloaded. The only certain way to ensure that a firearm has the chamber(s) empty is to open the chamber and visually and physically examine the

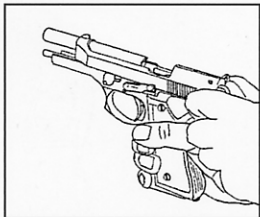

inside to see if a round is present.

Removing or unloading the magazine will not guarantee that a firearm is unloaded or cannot fire. Shotguns and rifles can be checked by cycling or removing all rounds and by then opening and inspecting the chamber so that a visual inspection of the chamber for any remaining rounds can be made.

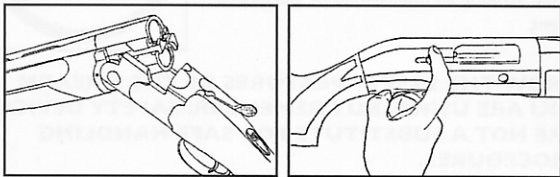

3. STORE YOUR FIREARM SO THAT CHILDREN CAN NOT GAIN ACCESS TO IT.

It is your responsibility to ensure that children under the age of 18 or other unauthorized persons do not gain access to your firearm. **To reduce the risk of accidents involving children, unload your firearm, lock it and store the ammunition in a separate locked location.** Please note that devices intended to prevent accidents - for example, cable locks, chamber plugs, etc. - may not prevent use or misuse of your firearm by a determined person. Firearm storage in a steel gun safe may be more appropriate to reduce the likelihood of intentional misuse of a firearm by an unauthorized child or person.

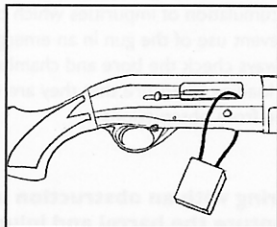
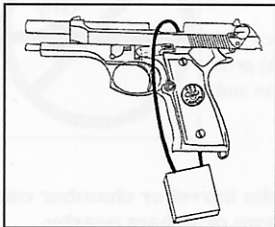



4. NEVER SHOOT AT WATER OR AT A HARD SURFACE.

Shooting at the surface of water or at a rock or other hard surface increases the chance of ricochets or fragmentation of the bullet or shot, which can result in the projectile striking an unintended or peripheral target.



5. KNOW THE SAFETY FEATURES OF THE FIREARM YOU ARE USING, BUT REMEMBER: SAFETY DEVICES ARE NOT A SUBSTITUTE FOR SAFE HANDLING PROCEDURES.

Never rely solely on a safety device to prevent an accident. It is imperative that you know and use the safety features of the particular firearm you are handling, but accidents can best be prevented by following the safe handling procedures described in these safety rules and elsewhere in the product manual. To further familiarize yourself with the proper use of this or other firearms, take a Firearms Safety Course taught by an expert in firearms use and safety procedures.

6. PROPERLY MAINTAIN YOUR FIREARM.

Store and carry your firearm so that dirt or lint does not accumulate in the working parts. Clean and oil your firearm, following the instructions provided

in this manual, after each use to prevent corrosion, damage to the barrel or accumulation of impurities which can prevent use of the gun in an emergency. Always check the bore and chamber(s) prior to loading to ensure that they are clean and free from obstructions.



Firing with an obstruction in the barrel or chamber can rupture the barrel and injure you or others nearby.

In the event you hear an unusual noise when shooting, stop firing immediately, engage the manual safety and unload the firearm. Make sure the chamber and barrel are free from any obstruction, like a bullet blocked inside the barrel due to defective or improper ammunition.

7. USE PROPER AMMUNITION.

Only use factory-loaded, new ammunition manufactured to industry specifications: CIP (Europe and elsewhere), SAAMI® (U.S.A.). Be certain that each round you use is in the proper caliber or gauge and type for the particular firearm. The caliber or gauge of the firearm is clearly marked on the barrels of shotguns and rifles and on the slide or barrel of pistols. The use of reloaded or remanufactured ammunition can increase the likelihood of excessive cartridge pressures, case-head ruptures or other defects in the ammunition that can cause damage to your firearm and injury to yourself or others nearby.

There is a broad array of .22LR ammunition made by many manufacturers in different brands and types. To ensure reliable operation, a semi-automatic firearm must be matched to a certain cartridge load. The Beretta 90 Series pistols in caliber .22LR have been designed for high quality standard and HV (High Velocity) ammunition. Beretta suggests that you try several boxes of a recommended brand/type of ammunition in your 90 Series pistols in caliber .22LR before you put it into regular use to determine reliability of ignition and performance of your ammunition. If issues occur, try different recommended brands until a reliable load is found. Based on our testing and evaluation, Beretta recommends the following ammunition for optimal performance:

- Federal Game-Shok
- CCI Standard
- CCI Stinger
- CCI MiniMag
- RWS HV
- Remington Golden Bullet
- Remington Thunderbolt

Other .22LR ammunition may also work well but should be evaluated for function and performance.



Notice: You should clean the barrel bore every 200-300 rounds with an appropriate firearm cleaning lead solvent to prevent lead build up which can lead to innacuracy and poor functioning.

8. ALWAYS WEAR PROTECTIVE GLASSES AND EARPLUGS WHEN SHOOTING.

The chance that gas, gunpowder or metal fragments will blow back and injure a shooter who is firing a gun is rare, but the injury that can be sustained in such circumstances can be severe, including the possible loss of eyesight. A shooter must always wear impact resistant shooting glasses when firing any firearm. Earplugs or other high-quality hearing protectors help reduce the chance of hearing damage from shooting.



9. NEVER CLIMB A TREE, FENCE OR OBSTRUCTION WITH A LOADED FIREARM.

Open and empty the chamber(s) of your firearm and engage the manual safety before climbing or descending a tree or before climbing a fence or jumping over a ditch or other obstruction. Never pull or push a loaded firearm toward yourself or another person. Always unload a firearm, visually and physically check to see that the magazine, loading mechanism and chamber are unloaded, and action is open before handing it to another person. Never take a firearm from another person unless it is unloaded, visually and physically checked to confirm it is unloaded, and the action is open.



10. AVOID ALCOHOLIC BEVERAGES OR JUDGMENT/REFLEX IMPAIRING MEDICATION WHEN SHOOTING.

Do not drink and shoot. If you take medication that can impair motor reactions or judgment, do not handle a firearm while you are under the influence of the medication.



11. NEVER TRANSPORT A LOADED FIREARM.

Unload a firearm before putting it in a vehicle (chamber empty, magazine empty). Hunters and target shooters should load their firearm only at their destination, and only when they are ready to shoot. If you carry a firearm for self-protection, leaving the chamber unloaded can reduce the chance of an unintentional discharge.

12. LEAD WARNING.

Discharging firearms in poorly ventilated areas, cleaning firearms, or handling ammunition may result in exposure to lead and other substances known to cause birth defects, reproductive harm, and other serious physical injury. Have adequate ventilation at all times. Wash hands thoroughly after exposure.

WARNING: It is YOUR responsibility to know and abide by Federal, State and Local laws governing the sale, transportation and use of firearms in your area.

WARNING: This firearm has the capability of taking your life or the life of someone else! Always be extremely careful with your firearm. An accident is almost always the result of not following basic firearm safety rules.

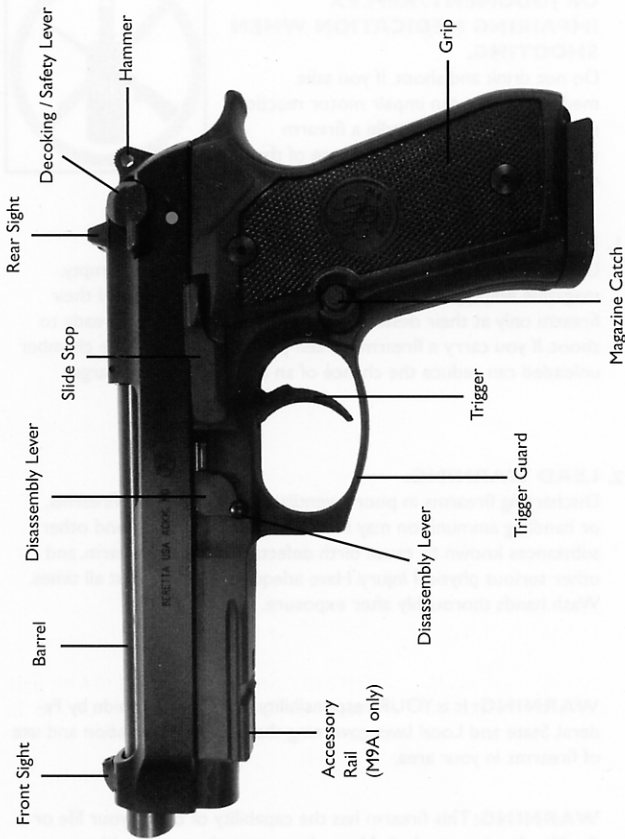

DESCRIPTION

The Beretta 90 Series semi-automatic pistols are primarily designed for military and police use. Due to excellent performance in competitive testing, 90 Series pistols are the choice of Military and Police Forces around the world. The characteristics of flawless reliability, handling safety, ammunition capacity and excellent accuracy, are the key attributes of the 90 series pistols. The Beretta 90 Series pistols in caliber .22LR deliver these same properties. This makes them the perfect training tool and authentic replica of Beretta 90 Series centerfire pistols.

SAFETY FEATURES

Automatic Firing Pin Safety

When the trigger is not pulled completely back, a blocking device secures the firing pin and prevents it from moving forward, even if the weapon should fall from a height and strike the ground muzzle-down.

Manual Safety-Decocking Lever

The Manual Safety-Decocking Lever allows safe hammer lowering over a chambered round. The rotation of the safety blocks and shields the firing pin from hammer strike. With the safety ON, the linkage between trigger and sear is disconnected.

WARNING: ALWAYS LEAVE THE MANUAL SAFETY ENGAGED (ON "SAFE") UNTIL YOU INTEND TO FIRE.

WARNING: TO USE YOUR FIREARM IN A SAFE MANNER, NEVER RELY SOLELY ON MECHANICAL FEATURES - ALWAYS BE EXTREMELY CAREFUL AND USE SAFE GUN HANDLING PRACTICES TO AVOID SITUATIONS THAT COULD LEAD TO AN ACCIDENT.

Chamber-Loaded Indicator

A small opening on top of the slide in the area of the breech face allows the inspection of the chamber to see if a cartridge has been loaded.



WARNING: TO VERIFY YOUR FIREARM IS UNLOADED, ALWAYS INSPECT THE OPEN CHAMBER AFTER THE MAGAZINE HAS BEEN REMOVED.

Empty Chamber Indicator

The empty chamber indicator (**fig. 1**) is a piece of polymer that simulates a cartridge. When the indicator is installed in the chamber the red tab clearly shows that the chamber is clear of any ammunition. The empty chamber indicator can also be used when dry-firing the gun.

OPERATIONAL FEATURES

Double Action/Single Action

Double Action offers the advantages of a longer, deliberate first shot trigger pull. In the rare instance of misfire due to a faulty cartridge, it is sufficient to pull the trigger again to repeat the percussion on the cartridge and to fire the round. In single action, a very light trigger pull allows rapid firing and increased accuracy.

Field Stripping

The disassembly lever is designed to allow an extremely quick and simple field stripping of the pistol. The major components can be quickly separated for cleaning and inspection.

Slide Stop

When the last round has been fired, the slide locks open signalling that the magazine is empty. The slide stop can also be used to close the slide when loading the pistol.

Magazine Capacity

The standard magazines on Beretta 90 Series caliber .22LR pistols hold 15 rounds. That makes training with these pistols as realistic as possible, because the magazines share the same capacity as the centerfire pistols. Due to various state regulations your pistol can also be equipped with a 10 or other round capacity magazine.

Ambidextrous Decocking / Safety Lever

This feature allows easier and quicker decocking and safety application by

left and right-handed shooters (**fig. 2+3**).

Reversible Magazine Release Button

The magazine Release can be reversed to allow easier access for left handed shooters.

NOTICE: Use a qualified gunsmith to reverse the magazine release.

Special Sights

Both, front and rear sights are designed for swift target acquisition. To aid sighting under low light conditions, the sights are equipped with white dot inlays. Sights can also be removed for different sight options or to make adjustments.

Combat Trigger Guard

The trigger guard is shaped and grooved to allow a functional rest of the index finger when shooting with a two hand grip.

Picatinny Rail on the Frame.

The M9A1 version of the pistol comes with a standard Picatinny rail (MIL STD 1913) under the barrel (**fig. 4**) for convenient mounting of a laser device, flashlight or other type of accessory.

WARNING: ALWAYS ENSURE THAT THE PISTOL IS UNLOADED, INCLUDING VERIFYING THAT THERE IS NO ROUND IN THE CHAMBER, BEFORE INSTALLING OR REMOVING AN ACCESSORY TO/FROM THE PISTOL RAIL. NEVER PLACE YOUR HAND IN FRONT OF THE MUZZLE.

GENERAL OPERATION

The Beretta 90 Series pistols in caliber .22LR are semiautomatic blow-back type firearms. Upon firing, the inertia of the fired cartridge pushes the slide back, ejects the spent cartridge, cocks the hammer and compresses the recoil spring. The slide will then automatically move forward to the closed position, feeding the next cartridge from the magazine into the chamber. The slide is designed to stay open after the last round has been fired and ejected.



SPECIFICATIONS

Operation	Semiauto
Locking System	Blowback
Caliber	.22LR
Safety	Ambidextrous manual with automatic firing pin safety
Action	Double Action/Single Action
Muzzle	Unthreaded, (Threaded barrels available as accessory)
Magazine Capacities	15 rounds / 10 rounds
Rear sight	Drift-adjustable for windage
Front sight	Drift-adjustable for windage, interchangeable front sights to adjust elevation

TECHNICAL DATA	Beretta M9-22	Beretta M9A1-22	Beretta 92FS-22
Overall length	217 mm 8.5 inch	217 mm 8.5 inch	217 mm 8.5 inch
Overall height	140 mm 5.5 inch	140 mm 5.5 inch	140 mm 5.5 inch
Width	38.6mm / 1.52 inch	38.6mm / 1.52 inch	38.6mm / 1.52 inch
Barrel length	135 mm 5.3 inch	135 mm 5.3 inch	135 mm 5.3 inch
Sight radius	155 mm 6.1 inch	155 mm 6.1 inch	155 mm 6.1 inch
Weight without the magazine	740 g / 1.63 lbs	740 g / 1.63 lbs	740 g / 1.63 lbs

LOADING AND FIRING

CAUTION: ALWAYS KEEP YOUR FINGER AWAY FROM THE TRIGGER WHENEVER YOU DO NOT INTEND TO FIRE. RETRACT THE SLIDE TO INSPECT THE CHAMBER TO MAKE SURE IT IS EMPTY.

LOADING THE MAGAZINE

- To load the magazine, remove it from the pistol by depressing the magazine release button (**fig. 5**)
- Hold the magazine in the left hand. With your right hand place a cartridge on the follower in front of the feed lips, press down and slide the cartridge completely back under the feed lips (**fig. 6**)
- Repeat until the magazine is fully loaded.
- Do not try to force more than the maximum indicated rounds into the magazine.

LOADING THE PISTOL AND THE CHAMBER

CAUTION: ALWAYS KEEP YOUR FINGER AWAY FROM THE TRIGGER WHENEVER YOU DO NOT INTEND TO FIRE.

NOTE: To avoid accidental discharge due to inadvertent trigger pull, keep the manual safety engaged "ON" during loading or unloading and keep the trigger finger away from the trigger.

- Engage the manual safety, by pushing the decocking-safety lever down all the way, so as to cover the red warning dot (**fig. 2**). This safety lever rotation blocks the firing pin from the hammer, lowers the hammer if cocked, and disconnects the trigger and sear.
- Push the loaded magazine into the pistol grip completely to ensure magazine release engagement.



Grasping the slide serrations with thumb and index finger, fully retract and release the slide (**Fig. 7**) to load the chamber.

CAUTION: THE PISTOL IS NOW CHAMBER LOADED, DECOCKED, MANUAL SAFETY ENGAGED. ALWAYS KEEP YOUR FINGER AWAY FROM THE TRIGGER WHENEVER YOU DO NOT INTEND TO FIRE.

NOTE: All Beretta 90 Series pistols described in this manual are equipped with an Automatic Safety which prevents firing pin inertia breech protrusion. This safety is overcome only by trigger pull.

To replace the round which has been chambered from the magazine:

- Remove the magazine from the pistol by depressing the magazine release button (**fig. 5**).
- Insert one more cartridge into the magazine.
Push the loaded magazine into the pistol grip completely to ensure magazine release engagement.

CAUTION: REMEMBER THAT YOU ARE HANDLING A LOADED WEAPON, WITH A LIVE ROUND IN THE CHAMBER.

Keep your finger away from the trigger whenever you do not intend to fire.

FIRING

WHEN READY TO FIRE:

- Aim the pistol and align front and rear sight on target.
- Release the manual safety by rotating the manual safety lever with a fully upward thumb pressure. The red warning dot can be seen when the manual safety is disengaged.
- Fire by squeezing the trigger.

NOTE: Since the hammer is decocked, the pull on the trigger will first cock the hammer and then release it. This firing mode is called **DOUBLE ACTION**.

The discharge will cycle the slide which, in turn, will eject the fired cartridge case, and cock the hammer. Then the slide will automatically close, feeding the next cartridge from the magazine into the chamber.

CAUTION: THE PISTOL IS NOW LOADED COCKED AND READY TO FIRE AGAIN. KEEP YOUR FINGER AWAY FROM THE TRIGGER WHENEVER YOU DO NOT INTEND TO FIRE.

- Squeeze the trigger to fire again.

NOTE: Since the hammer is cocked, the pull on the trigger releases the hammer. This firing mode is called **SINGLE ACTION**. After the first shot the pistol will remain in single action mode.

- If the hammer is fully-lowered, the safety OFF, and single action mode is desired, manually retract the hammer to its fully-cocked position. WHEN READY TO FIRE, squeeze the trigger.
- When the last round has been fired the slide remains open (**fig. 8**).
- To fire again remove the empty magazine and insert a loaded one.
- Press the slide stop, to close the slide and to load the chamber (**fig. 9**).

CAUTION: THE PISTOL IS NOW CHAMBER LOADED, COCKED AND READY TO FIRE AGAIN. KEEP YOUR FINGER AWAY FROM THE TRIGGER WHENEVER YOU DO NOT INTEND TO FIRE. ENGAGE THE MANUAL SAFETY AND/OR LOWER THE HAMMER BY ROTATING THE DECOCKING SAFETY LEVER.



UNLOADING THE PISTOL AND THE CARTRIDGE CHAMBER

- Engage the manual safety (fully down; red dot covered). If cocked, rotating the decocking lever downward will lower the hammer and engage the safety
- Depress the magazine release button to remove the magazine from the pistol.
- Grasping the slide serrations with thumb and index finger, fully retract the slide to remove the chambered cartridge .
- **ONCE SURE THAT THE CHAMBER IS EMPTY AND THE CARTRIDGE HAS BEEN EJECTED**, release the slide.

UNLOADING THE MAGAZINE

- To unload the magazine, with one hand, grasp the magazine box, bottom down and front end forward. With the tip of the thumb firmly press down on the cartridge rim and push. As the bullet moves forward, tip it slightly upward with the index finger.
- Repeat until the magazine is unloaded.

DISASSEMBLY

Every time the pistol is fired or at least once a month, cleaning and lubricating is recommended.

FIELD STRIPPING

CAUTION: MAKE SURE THE PISTOL IS UNLOADED. IF NOT, UNLOAD FOLLOWING THE "UNLOADING THE PISTOL" PROCEDURE. (P. 18)

- Remove magazine by depressing magazine release button
- Hold pistol in the right hand; with left forefinger press disassembling lever release button and with left thumb rotate the disassembling lever clockwise until it stops (**fig. 10**).
- Pull the slide barrel assembly forward with locking block, recoil spring and spring guide (**fig. 11**).
- Slightly press recoil spring and spring guide towards muzzle to separate them from the barrel (**fig. 12**).

CAUTION: SPRING AND SPRING GUIDE ARE UNDER TENSION.

- Lift spring guide and recoil spring, letting the spring out slowly, as it is under tension (**fig. 13**).
- Remove the barrel locking assembly from slide (**fig. 14**).

NO FURTHER DISASSEMBLY IS RECOMMENDED UNLESS DONE BY A COMPETENT GUNSMITH.



CLEANING AND LUBRICATING

BARREL CLEANING AND LUBRICATING

- Spray a bore brush with CLP (cleaner lubricant preservative) gun oil. Insert the brush into the barrel from the chamber and scrub the chamber and bore thoroughly.
- Dry chamber and bore by pushing a patch through the chamber and bore. Keep changing the patch until it emerges clean.
- Clean the locking block with a cloth soaked in gun oil.
- Lightly oil the inside and outside of the barrel, using a clean patch soaked in gun oil. Lightly oil the locking block.

SLIDE CLEANING AND LUBRICATING

- Clean slide with a cloth and/or brush soaked in gun oil, paying special attention to the breech face and extractor, slide rails and underside of breech. Wipe clean.
- Lightly oil the slide. Apply a few drops of oil around the extractor, firing pin block and safety and operate the parts to ensure oil penetration and free movement.

RECOIL SPRING AND SPRING GUIDE LUBRICATING

- Lightly oil recoil spring and spring guide with gun oil. After long use it may be necessary to first clean with gun oil and a brush.

FRAME CLEANING AND LUBRICATION

- With oil soaked rag or brush, clean all areas covered by gunpowder residue and dirt.
- Wipe clean and lightly lubricate rails and moving parts. Be

- Be sure to oil the disassembly lever, magazine catch, slide stop, trigger system, hammer, sear, and the levers in front of the hammer.

MAGAZINE CLEANING AND CARTRIDGE ROTATION

- Be sure to thoroughly clean the magazine(s). After cleaning, wipe with a lightly oil moistened rag.
- If the pistol is carried chamber and magazine loaded, it is important to periodically unload all magazines for cartridge inspection.

ASSEMBLY

Assemble following the Field Stripping procedure in reverse order. It is advisable to pay attention to the following points:

- Engage safety
- The barrel should rest perfectly flush against the slide (the extractor must lodge in its groove in the barrel) (**fig. 15**).
- The recoil spring guide head should lodge in the center of its groove in the locking block (**fig. 12**).
- When rotating the disassembly lever, the slide should be in the closed position (aligned with or beyond the rear side of frame).

Make sure the barrel locking assembly is in rear most position. If necessary push the barrel locking assembly to the rear using the open area at the slide.



AMMUNITION

AMMUNITION (CARTRIDGE) NOTICE: Beretta specifically disclaims responsibility for any damage or injury whatsoever occurring in connection with, or as the result of, the use in the Beretta 90 Series pistol in caliber .22LR of faulty, non standard, or "remanufactured", or hand-loaded (reloaded) ammunition, or cartridges other than those for which the firearm was originally chambered.

Use only high-quality, commercially-manufactured ammunition that is manufactured in accordance with CIP (Europe and elsewhere) or SAAMI® (USA) standards. Be certain that the ammunition is the appropriate caliber and loading for the firearm and is clean, dry, and in good condition. The cartridge designation for your firearm is marked on the sides of the slide.

USE PROPER AMMUNITION.

Only use factory-loaded, new ammunition manufactured to industry specifications: CIP (Europe and elsewhere), SAAMI® (U.S.A.). Be certain that each round you use is in the proper caliber or gauge and type for the particular firearm. The caliber or gauge of the firearm is clearly marked on the barrels of shotguns and on the slide or barrel of pistols. The use of reloaded or remanufactured ammunition can increase the likelihood of excessive cartridge pressures, case-head ruptures or other defects in the ammunition that can cause damage to your firearm and injury to yourself or others nearby.

There is a broad array of .22LR ammunition made by many manufacturers in different brands and types. To ensure reliable operation, a semi-automatic firearm must be matched to a certain cartridge load. The Beretta 90 Series pistol in caliber .22LR has been designed for high quality standard and

HV (High Velocity) ammunition. Beretta suggests that you try several boxes of a recommended brand/type of ammunition in your 90 Series pistol in caliber .22LR before you put it into regular use to determine reliability of ignition and performance of your ammunition. If issues occur, try different recommended brands until a reliable load is found. Based on our testing and evaluation, Beretta recommends the following ammunition for optimal performance:

- Federal Game-Shok
- CCI Standard
- CCI Stinger
- CCI MiniMag
- RWS HV
- Remington Golden Bullet
- Remington Thunderbolt

Other .22LR ammunition may also work well but should be evaluated for function and performance.

Notice: You should clean the barrel bare every 200-300 rounds with an appropriate firearm cleaning lead solvent to prevent lead build up which can lead to inaccuracy and poor functioning.

WARNING: CAREFULLY INSPECT EACH CARTRIDGE BEFORE IT IS LOADED IN THE MAGAZINE. BE CERTAIN THE CARTRIDGE CASES ARE NOT SPLIT, DEFORMED, OR THE CARTRIDGES DO NOT POSSESS ANY OTHER DENTS OR DEFECTS.

Do not fire old ammunition in this firearm. Primers, powder, cartridge cases, and bullets can deteriorate with time and cause damage to the firearm, or injury to the shooter or others.

WARNING: DO NOT USE NON-STANDARD, OR "REMANUFACTURED", OR HAND-LOADED (RELOADED) AMMUNITION, OR CARTRIDGES OTHER THAN THOSE FOR WHICH THE FIREARM WAS ORIGINALLY CHAMBERED. BERETTA ASSUMES NO LIABILITY FOR INCIDENTS OCCURRING THROUGH THE USE OF NON-STANDARD OR INCORRECT AMMUNITION. USE OF RELOADED OR INCORRECT AMMUNITION WILL VOID THE MANUFACTURER'S WARRANTY.



TROUBLESHOOTING

1. Failure to fire

If, while firing, the trigger is pulled and the firearm does not immediately fire:

CEASE FIRING IMMEDIATELY!

- Keep the firearm pointed in a SAFE direction in the event a “hang-fire” has occurred. A hang-fire occurs when there is a delay in a cartridge’s ignition.
- With the firearm pointed in a SAFE direction, wait one (1) full minute.
- After one (1) full minute has elapsed, completely unload the firearm by following the UNLOADING instructions in this manual.
- Carefully inspect your ammunition.
- Immediately consult qualified personnel such as a gunsmith if the firing pin indent on a fired cartridge’s rim is light or does not exist.

WARNING: NEVER ATTEMPT TO FIRE AMMUNITION THAT DID NOT FIRE THE FIRST TIME.

2. Firing with an obstruction in the barrel or chamber can rupture the barrel and injure you or others nearby.

- In the event you hear an unusual noise when shooting, stop firing immediately, engage the manual safety and unload the firearm. Make sure the chamber and barrel are free from any obstruction, like a bullet blocked inside the barrel due to defective or improper ammunition.

WARNING: IF ANOTHER CARTRIDGE IS FIRED INTO AN OBSTRUCTED BARREL, A CATASTROPHIC FAILURE CAN RESULT.

- With the gun pointed in a SAFE DIRECTION, COMPLETELY UNLOAD the firearm by following the unloading instructions.
- Using the disassembly instructions check to be sure there are no obstructions in the barrel. If a barrel obstruction is detected, qualified personnel, such as a gunsmith, must remove the obstruction and inspect the firearm before it can be fired.



MALFUNCTION	PROBABLE CAUSE	REMEDY
Failure to feed	Defective cartridge	Inspect and replace cartridge
Mis-fire	Defective cartridge	Pull the trigger once more or replace cartridge
Does not extract or defective extraction	Dirty cartridge chamber	Clean and lubricate cartridge Chamber
	Defective or dirty ammunition	Replace or clean cartridges
	Dirt under the extractor	Clean the extractor seat

WARNING: DO NOT ATTEMPT TO MAKE REPAIRS TO ANY FIREARM WITHOUT PROPER KNOWLEDGE OR TRAINING. DO NOT ALTER PARTS OR USE SUBSTITUTE PARTS NOT MADE BY BERETTA. ANY NECESSARY ALTERATIONS OR ADJUSTMENTS TO THE OPERATING MECHANISM SHOULD BE PERFORMED BY THE MANUFACTURER.

WARNING: DO NOT ATTEMPT TO ALTER THE INTERNAL PARTS OF YOUR PISTOL'S FIRING MECHANISM. ALTERING INTERNAL PARTS CAN CAUSE UNSAFE CONDITION.

MAINTENANCE

The firearm should be cleaned as soon as possible after firing. Use only high-quality, commercially-available firearm cleaning solvents and cleaning equipment.

THE FIREARM SHOULD NOT BE DISASSEMBLED FOR CLEANING BEYOND WHAT IS DESCRIBED BELOW. ONLY QUALIFIED PERSONNEL (FOR EXAMPLE, GUNSMITHS) WHO ARE FAMILIAR WITH THESE FIREARMS SHOULD CONDUCT FURTHER DISASSEMBLY.

WARNING: DO NOT ATTEMPT TO MAKE REPAIRS TO ANY FIREARM WITHOUT PROPER KNOWLEDGE OR TRAINING. DO NOT ALTER PARTS OR USE SUBSTITUTE PARTS NOT MADE BY BERETTA. ANY ALTERATIONS OR ADJUSTMENTS THAT MAY BE NECESSARY TO THE OPERATING MECHANISM SHOULD BE PERFORMED BY THE MANUFACTURER OR A BERETTA AUTHORIZED SERVICE CENTER.

EXCESS OIL AND GREASE OBSTRUCTING THE BORE, EVEN PARTIALLY, IS VERY DANGEROUS WHEN FIRING AND MAY CAUSE BARREL RUPTURE AND SERIOUS INJURY TO THE SHOOTER AND BYSTANDERS. NEVER SPRAY OR APPLY OIL TO CARTRIDGES. USE LUBRICANTS PROPERLY. YOU ARE RESPONSIBLE FOR THE PROPER CARE AND MAINTENANCE OF YOUR FIREARM.



Notice: It is advisable to carry out the field stripping and the assembly operations over a table to catch components should they drop.

Disassemble the firearm as previously described in this manual.

CAUTION: MAKE SURE THE PISTOL IS UNLOADED. IF NOT, UNLOAD FOLLOWING THE "UNLOADING THE PISTOL" PROCEDURE. (P. 18)

CLEANING AND LUBRICATION

- Visually inspect to verify that no ammunition remains anywhere in the firearm.
- Remove fouling from the breech, magazine lips, follower, and receiver with a brush and a cloth.
- Clean the barrel with bore solvent and a brush and then dry it with cleaning patches. Always begin at the chamber end.
- Repeat until the barrel is clean.
- Thoroughly clean the bolt assembly area with a brush and cloth to remove powder residue and debris.
- Apply a thin coat of oil to all metal parts.
- Make sure the firing pin assembly is in the correct position.
- Apply 2 drops of gun oil to the main spring.
- Apply 1 drop of gun oil to the extractor.
- Apply 1 drop of gun oil to each end of firing pin assembly.
- Reassemble the firearm and check for proper function.
- Verify the gun is ON SAFE.
- Insert an EMPTY magazine and retract the bolt handle so that the bolt assembly remains in the open position.
- Insert the red tab (Chamber Unloaded Indicator).
- Remove the magazine.
- Pull the bolt handle rearward, then release it to close the bolt assembly.

WARNING: THE FIREARM SHOULD ALWAYS BE STORED UNLOADED, WITH THE BOLT IN THE CLOSED POSITION, THE SAFETY ENGAGED AND THE HAMMER DECOCKED.
(SEE PAGE 16).

WARNING: STORE FIREARMS AND AMMUNITION SEPARATELY, EACH IN ITS OWN LOCKED CONTAINER, AND AWAY FROM CHILDREN AND UNAUTHORIZED ADULTS!

WARNING: BE CERTAIN YOUR FIREARM IS UNLOADED BEFORE SHIPPING OR TAKING IT TO THE DEALER.

CAUTION: DO NOT STORE YOUR FIREARM IN A LEATHER, FABRIC OR CANVAS HOLSTER OR CASE. THESE MATERIALS ATTRACT MOISTURE, EVEN THOUGH THEY MAY APPEAR TO BE PERFECTLY DRY.



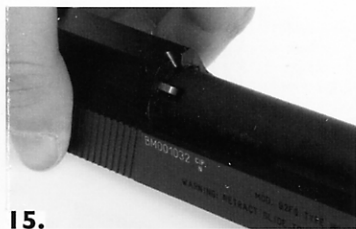
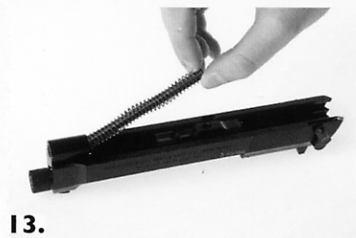



BERETTA

Beretta USA Corp.
17601 Beretta Drive
Accokeek, MD 20607
Tel. (301) 283-2191
www.berettausa.com